

# KTM

## Conductive Plastic Potentiometric Position Transducer



### Characteristic:

1. KTM The sensor is compact and ideal for small displacement measurements in a variety of small devices.
  2. The joint is designed with a margin and with M4 threaded connection for more flexible measurement.
  3. No electrical signal changes after the theoretical electrical stroke, the installation is simpler.
  4. Ideal for a wide range of small
- Installation dimension drawing:

mechanical devices, valves, test tools and benches

### Advantage :

- Small size
- Excellent linearity
- Higher resolution 0.01mm
- High running speed
- Protection level IP65
- Configurable voltage and current (2-wire, 3-wire) module

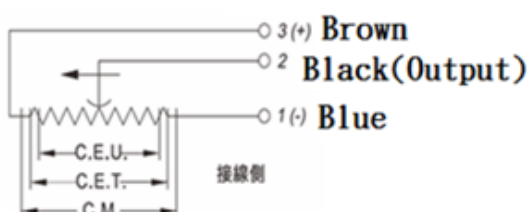
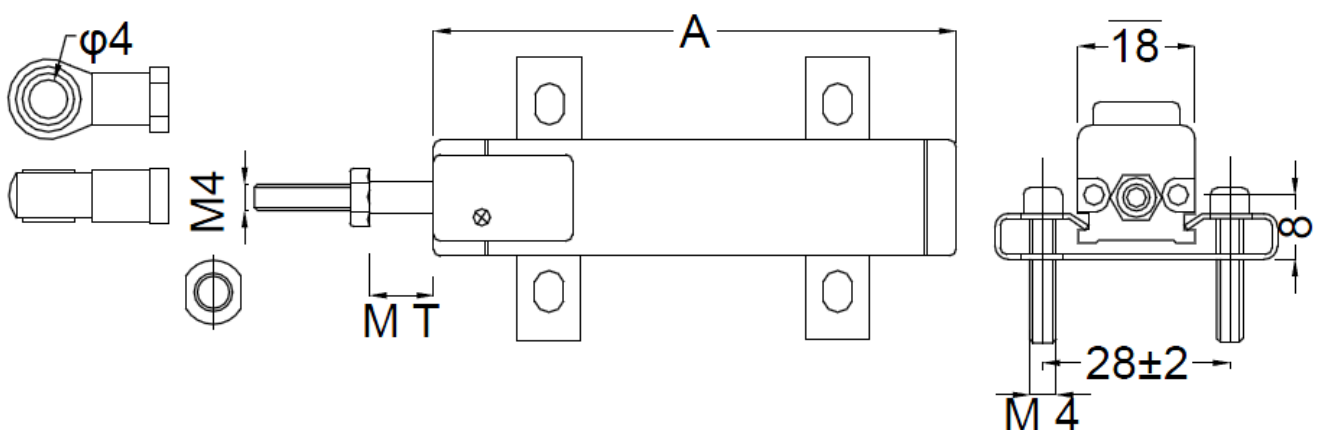

### Shipping standard:

brackets x2

(M4) Screws x4

Fish eye connector OR Universal joint x1

# KTM Conductive Plastic Potentiometric Position Transducer

	KTM	KTM	KTM	KTM	KTM	KTM	KTM	KTM	KTM	KTM
Electrical-parameters										
Model size	25	50	75	100	125	150	175	200	225	250
Nominal stroke (mm)	25	50	75	100	125	150	175	200	225	250
Electric stroke (mm)	25.5	50.5	75.5	101	126	151	176.5	201.5	226	252
Standard R(KΩ)	5	5	5	5	5	5	5	5	5	5
R tolerance	±20%									
Independent	0.3	0.25	0.15	0.1	0.1	0.08	0.08	0.05	0.05	0.05
Linearity(%)										
Repeatability precise	0.01mm									
Cusor current	≤1 μA									
Max cusor current	10mA									
Max power supply	42V									
Volts										
Coefficient Volts to				典型值	5					
Temp	ppm/K									
Insulation R	≥ 10M									
(500VDC, 1bar, 2s)	Ω									
Insulation strength	≤100 μA									
(50Hz, 2s, 1bar, 500VDC)										
Mechanical Parameter										
Shell Length(A)	Stroke+43mm									
Mechanical stroke(M)	30.5	55.5	80.5	106	131	156	181.5	206.5	231.5	257
Operation force										
Ball head allows displacement	±5° 偏差 ±0.5mm 的平行 偏差									
Vertical installation	≤0.4N									
Horizontal installation	≤1.1N									
Operation temperature	-40				~	100°C				
Life time	>50X 10 <sup>6</sup>					次				
Shock	50g					6ms				
Max speed	5m/s					最大				
Protection class	IP65									

# KTM

## Conductive Plastic Potentiometric Position Transducer

	KTM	KTM
<b>Electrical-parameters</b>		
Model size	275	300
Nominal stroke (mm)	275	300
Electric stroke (mm)	277	302
Standard R(KΩ)	5	5
R tolerance		±20%
Independent	0.05	0.05
<b>Linearity(%)</b>		
Repeatability precise		0.01mm
Cusor current		≤1 μA
Max cusor current		10mA
Max power supply		42V
<b>Volts</b>		
Coefficient Volts to	典型值	5
Temp		ppm/K
Insulation R		≥ 10M
(500VDC, 1bar, 2s)		Ω
Insulation strength		≤100 μA
(50Hz, 2s, 1bar, 500VDC)		
<b>Mechanical Parameter</b>		
Shell Length(A)	Stroke+43mm	
Mechanical stroke(M)	282	307
<b>Operation force</b>		
Ball head allows displacement	±5° 偏差	±0.5mm 的平行 偏差
Vertical installation		≤0.4N
Horizontal installation		≤1.1N
Operation temperature	-40	~ 100°C
Life time		>50X 10 <sup>6</sup> 次
Shock	50g	6ms
Max spead		5m/s 最大
Protection class		IP65