

KPZ Miniature cylindrical linear displacement sensor



Characteristic:

1. Improved design to meet measurement needs for a variety of conditions ◦
2. The sensor is rugged and shock-resistant ◦
3. No electrical signal output changes after theoretical electrical travel, making installation easier ◦

Advantage :

- Long service life, up to 50×10^6

Installation dimension drawing:

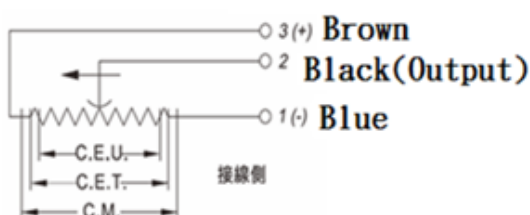
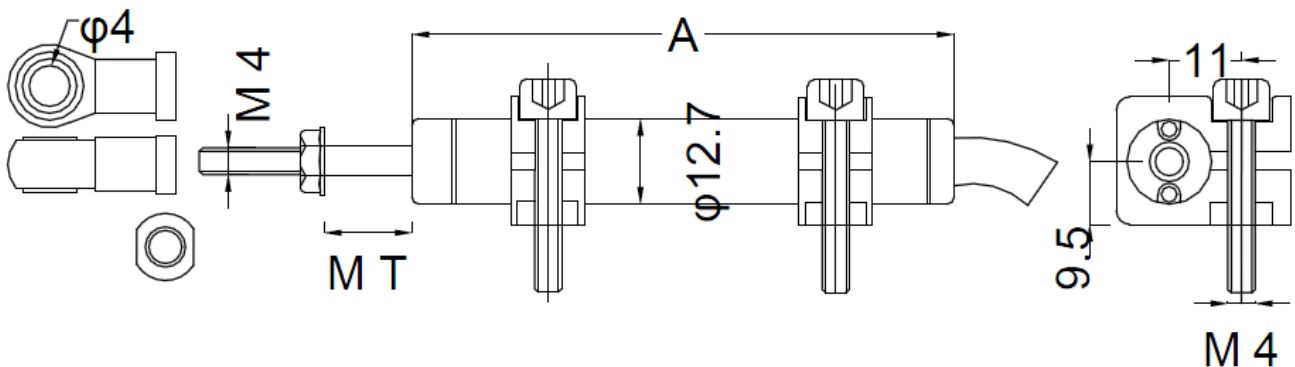

times ◦

- Excellent linearity ◦
- Excellent linearity 0.01mm ◦
- High running speed ◦
- Protection level IP65 ◦
- Configurable voltage and current (2-wire, 3-wire) modules

Shipping standard:

- brackets x2
- brackets x2
- (M4) Screws x4

KPZ

Miniature cylindrical linear displacement sensor

	KPZ	KPZ	KPZ	KPZ	KPZ	KPZ	KPZ	KPZ	KPZ	KPZ
Electrical-parameters										
Model size	50	75	100	125	150	175	200	225	250	300
Nominal stroke (mm)	50	75	100	125	150	175	200	225	250	300
Electric stroke (mm)	50.5	75.5	101	126	151	176.5	201.5	226.5	252	302
Standard R(KΩ)	5	5	5	5	5	5	5	5	5	5
R tolerance	±5%									
Independent	0.25	0.15	0.1	0.08	0.08	0.08	0.05	0.05	0.05	0.05
Linearity(%)										
Repeatability precise	0.01mm									
Cusor current	≤1 μA									
Max cusor current	10mA									
Max power supply	42V									
Volts										
Coefficient Volts to	5									
Temp	ppm/K									
Insulation R	≥ 10M									
(500VDC, 1bar, 2s)	Ω									
Insulation strength	≤100 μA									
(50Hz, 2s, 1bar, 500VDC)										
Mechanical Parameter										
Shell Length(A)	100.5	125.5	151	176	201	226.5	251.5	276.5	302	352
Mechanical stroke(M)	55.5	80.5	106	131	156	181.5	206.5	231.5	257	307
Vertical installation				±3°	偏差	±0.5mm	的平行	偏差		
Horizontal installation	≤0.4N									
Environmental parameter	≤1.1N									
Operation temperature										
Life time				-40	~	100°C				
Shock					>50X 10 ⁶	次				
Protection class					50g	6ms				
Electrical-parameters					10m/s	最大				
Model size	IP65									